

Intro to Driving Derby Competitions



Compiled & Presented by Debby Donovan

Based on 2022 ADS Rulebook: Appendix CD-C – Driving Derby (DD)

Driving Derby Overview

- **Course** consists of cones (6 – 16 pairs) + marathon-type obstacles (min of 2, max of 4)
- A “**round**” is a timed run through the course (timed from Start to Finish) - Each competitor performs the course one or more times (usually twice)
- ★ - **Penalties** are given as seconds and added to the times for the rounds
- When the course is ready, the official will give the driver a **signal to start** (do not start before the signal or you’ll incur a 10 sec penalty and have to restart!)
- **Gaits:** Any gait (walk, trot, canter) except no cantering in Training level

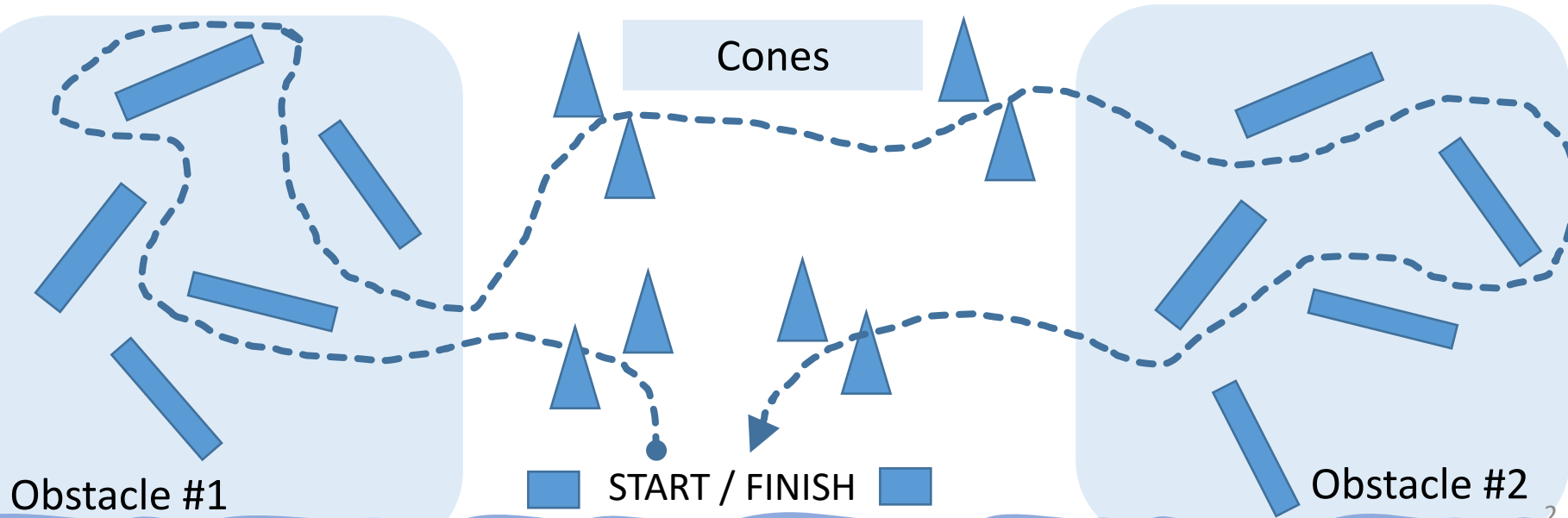

Course – Marathon Obstacles

- Marathon obstacles have “gates” with letters (A, B, C, D, E)
 - Must go through each gate in the correct order (A, then B, then C, etc.)
 - Must go through each gate in the correct direction as indicated by the colored letters (*always “red on right”*)
- After each gate has been driven, it becomes “open”
- ★ • There are no official entrance/exit gates to each obstacle
- To correct a course error: drive through the missed gate before continuing the remaining gates in the correct order

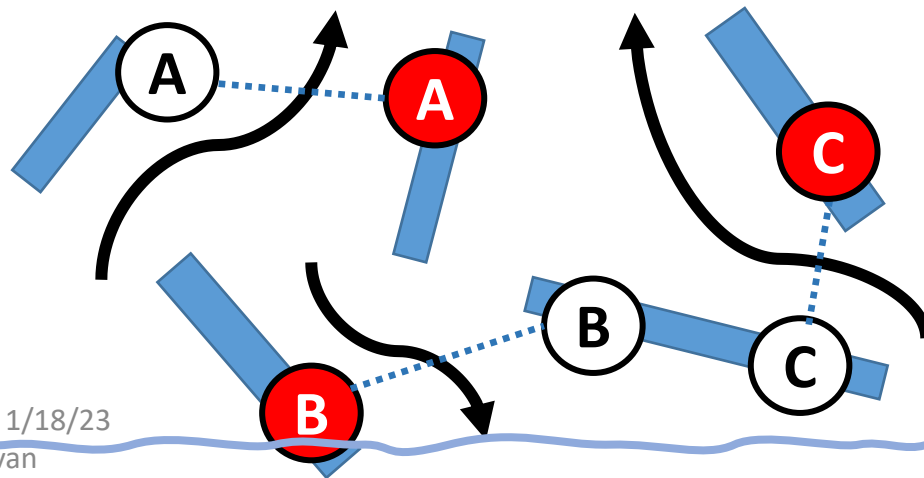

Course - Cones

- Cone pairs are numbered (1, 2, 3, etc.)
 - Must go through each pair of cones (“gates”) in the correct order (1, then 2, then 3, etc.)
 - Must go through each pair of cones in the correct direction as indicated by the colored numbers (*always “red on right”*)
- Each pair of cones can only be driven once, in numeric order
- After each pair of cones has been driven, it stays “live” (elimination if you drive through again – this is different from gates in a hazard)
- You cannot correct a cones course error (penalty: elimination)

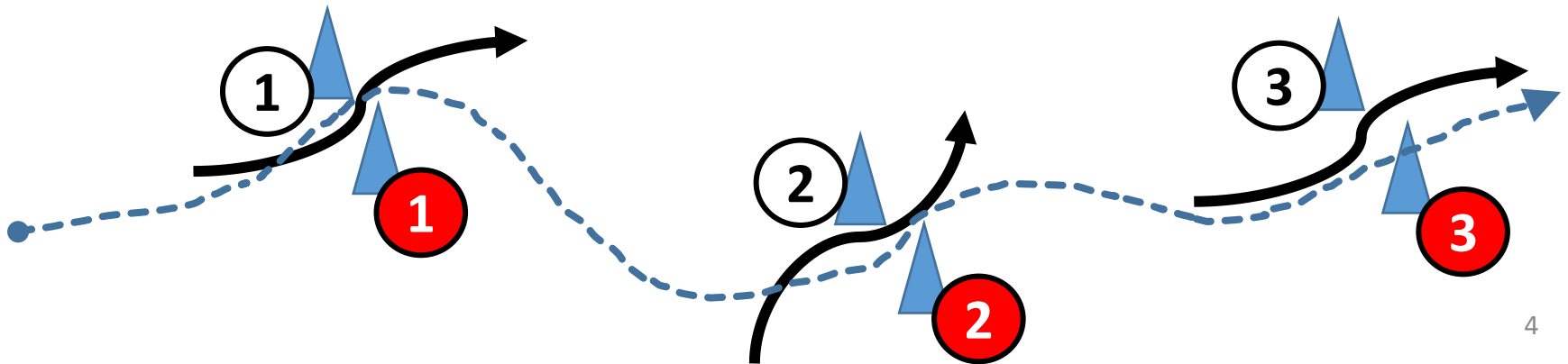

Example Derby Course

HAZARD #2

HAZARD #1

Route

Start >
Cones 1-3 >
Hazard 1 >
Cones 4-9 >
Hazard 2 >
Cones 10-12 >
Finish

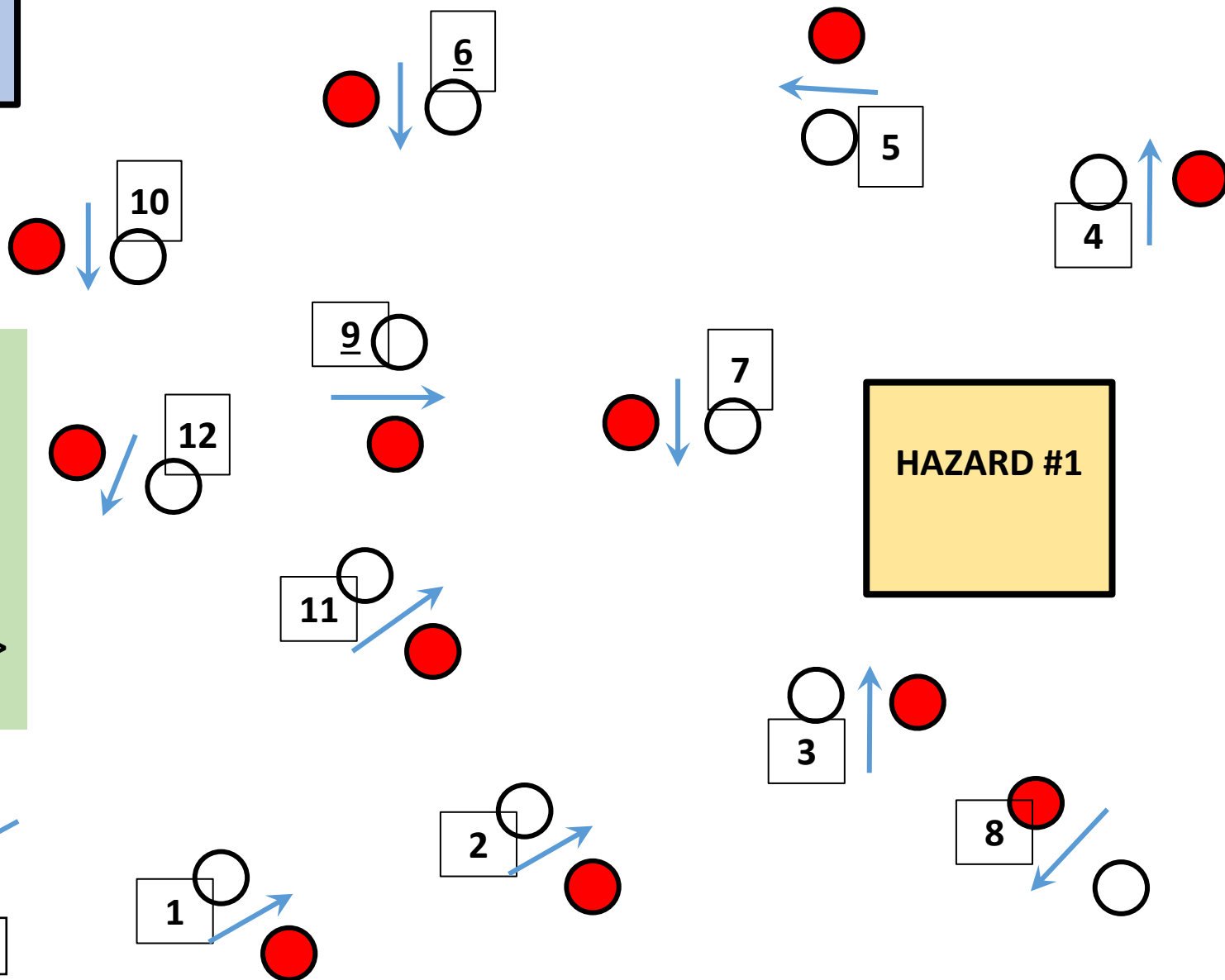
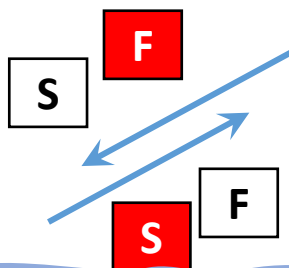

HAZARD #1

Walk/Trot – A, B, C
Trot/Canter – A, B, C, D

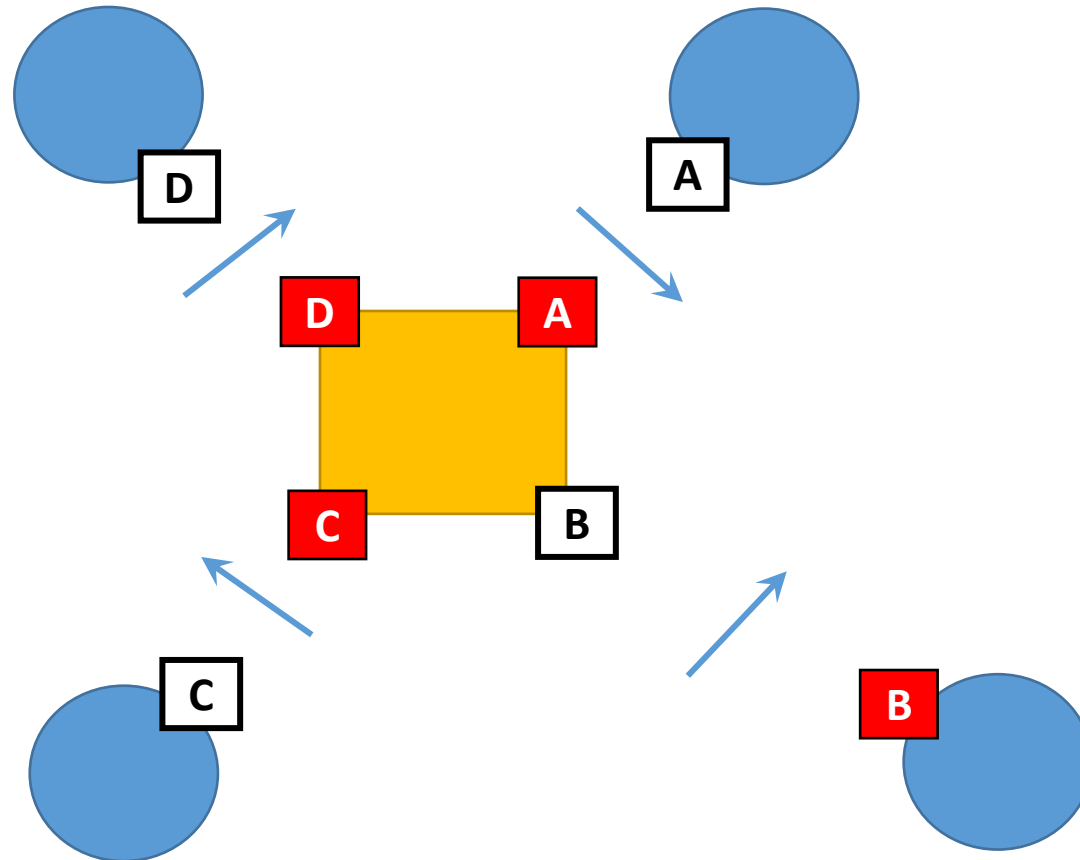

Turnout

- **Carriage:** Marathon-type carriage or cart with iron or solid rubber tires is encouraged (but not required).
- **Attire:** Marathon-type attire is appropriate.
- **Harness:** Bridle must have noseband; breeching required for all single turnouts & all carriages without brakes.



- **Safety:** Helmets (meeting ASTM/SEI standards) & safety vests required for driver & groom/navigator.
- **Groom/navigator:** Required for all except single VSE and single Small Pony.
- **Whip** required.

Photos from a BVDC Driving Derby

(held in June 2021 at Chapter One Farms, NJ)



Derby Scoring

- **ALL SCORES ARE IN SECONDS (not points)**
- **Penalties** are in seconds (not points)
- **Score** for one round = (a) + (b)
 - (a) Total time to complete the course (from START to FINISH)
 - (b) Penalties
- **Final competitor score** is the sum of scores for all rounds
- **Lowest time (score) wins!**

Example:

Round 1		Round 2		Total Time
Time	Penalties	Time	Penalties	
1:37	:20	1:18	:05	3:20

Types of Penalties

1. Time added to score
2. Just time lost
3. Elimination



Penalties: *Time Added to Score*

Description of Violation	Penalty
A dislodged element is knocked down by any means (e.g., ball down from a cone)	5 seconds
Causing an obstacle to be rebuilt (clock stops); <i>added to penalty for dislodged element</i>	5 seconds
Starting before the signal from the official	10 seconds
Dismounting while carriage is in motion	10 seconds
Corrected course in marathon obstacle	20 seconds
Groom uses the reins, whip or the brake	20 seconds
Cantering for more than 3 seconds in Training (walk/trot) division per occurrence	20 seconds

No Penalties: *Just Time Lost*



- First or second disobedience
- Groom(s) or Driver intentionally dismounting, first or second time
- Groom(s) or Driver intentionally dismounting and remounting before next numbered gate or finish

Penalties: *Elimination!*

“the big E”

- Failing to pass through start or finish gates
- Course error in cones: Numbered cones obstacle driven backwards, out of order, or more than once
- Course error in marathon obstacle not corrected
- Third disobedience
- Groom not on carriage when passing Finish Line
- Groom(s) or Driver intentionally dismounting for third time
- Failure to dismount to repair broken harness
- Groom(s) or Driver intentionally dismounting and remounting after next numbered gate or the Finish Line
- The carriage does not halt for a groom or driver remount
- Driver unintentional dismount
- Carriage turnover
- Excessive use of whip

Video of a Driving Derby

(courtesy of the ADS)

URL: <https://youtu.be/xuhvfusBxcQ>



Jeff and Jenn Morse and SBS Risky Business (23 year old Morgan) at Orleton Super Derby 2015

BVDC Driving Derby Competitions in 2023



Sat. June 24th

Sat. Sept 9th

***Location: Fair Hill NRMA, MD
Gallaher Rd area***